

# **PALMER**

**MANUFACTURING & SUPPLY, INC.**

**CHECK  
US OUT  
online**

[www.palmermfg.com](http://www.palmermfg.com)

## **Palmer No-Bake Machinery and Systems**

### **Machinery**

- Continuous Sand Mixers
- Molding Systems – Rollover, Carousel, Conveyor Loop
- Sand Reclamation Systems
- Coremaking – No-Bake, Cold Box, Shell, Core Knock-Out
- Retrofit Pumping Systems
- Rollover Draw Machines – C-Frame, Barrel
- Sand Conditioning – Sand Heater/Cooler/Classifiers
- Mold Preheaters and Dryers
- Mold Handlers
- Compaction Tables
- Mold and Core Coating – Spray, Flow
- Foundry Efficiency Tools
- Bulk Storage
- Feeders – Powder and Granular
- Melt Shop – Ladles, Furnaces, Degasser

### **Systems**

- No-Bake Molding Systems
- Completely Integrated Sand Reclamation Systems

### **Engineering**

- No-Bake Systems, Design & Lay-out
- Custom Designed and Engineered Machines
- Testing
- Service

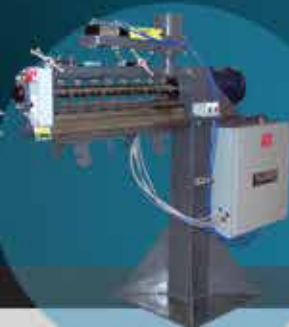

**Tel: 937.323.6339 • Fax: 937.323.2709**  
**[sales@palmermfg.com](mailto:sales@palmermfg.com)**

**U.S. and Canada**



**800.457.5456**

### M-Series XLD High Speed Continuous Mixers

Considered the Industry Standard in sand mixing, Palmer's line of high speed continuous mixers are built tough. Tungsten carbide tipped mixing blades provide long life, while the direct drive system ensures low maintenance. Standard features: dual mixing chamber doors (both sides for easy cleaning and maintenance, no tools required), high torque pump drive motors for precise resin metering, air assisted chemical injection (a 1980 Palmer innovation), and high speed operation makes the M-Series XLD the most rugged, reliable and best performing continuous mixer on the market. Outputs 15 – 5,000 lbs per minute. Standard control systems start with Zelio smart relay systems up to complete integrated Ethernet capable PLC/HMI systems.

Min-Max Output	lb/min	MTPH
M-50 XLD	15 - 75 lb/min	.4 - 2 MTPH
M-100 XLD	50 - 150 lb/min	1.4 - 4 MTPH
M-200 XLD	70 - 250 lb/min	1.9 - 7 MTPH
M-300 XLD	150 - 600 lb/min	4 - 16 MTPH
M-500 XLD	300 - 1100 lb/min	11 - 30 MTPH
M-1000 XLD	400 - 1700 lb/min	21 - 51 MTPH
M-2000 XLD	1000 - 3000 lb/min	27 - 81 MTPH
M-3000 XLD	2000 - 5000 lb/min	55 - 135 MTPH



M-200 XLD



M-50 XLD



M-50 XLD



Portable Cube Mixer



M-300 XLD



## M-2000 XLD

### Standard Features

- Rugged - heavy-duty construction designed for years of use and abuse with minimal maintenance.
- Simple design – easy to operate/maintain.
- Multiple doors for complete access to both sides of mixing chamber.
- Tungsten-carbide tipped mixing blades for increased life. Twice the thickness of others.
- Precise digital A.C. or D.C. driven resin pumps.
- Supplied 100% complete and fully assembled for easy, quick installation.
- Many options available - mixer can be custom fitted to match the application's exact requirements.
- Replacement parts available from Palmer or from a high quality industrial supply house in your area. Standard off-the-shelf components are used wherever possible so that parts availability is good and affordable.
- One year warranty.
- Capacity: 1000-3000 lb/min.



Control Panel



Electromechanical Power Rotation



RFID Tag Read and Write Station

### Shake-Out Deck / Attrition Mill (SDAM)

Palmer's Shake-Out Deck / Attrition Mill is a low level shake-out deck with integral attrition mill. This deck is low level and requires no pit, making loading and casting removal an ergonomically correct and safer operation. The SDAM reduces molds and lumps to grain size. Labor saving features include no pit for less clean-up, large easy clean-out doors, and accessible screens. There are 5 sizes available with throughputs up to 22 TPH (20MTPH) and deck loads to 25,000 lbs, to fit any budget and performance level. Our heavy-duty systems are completely integrated for use with all chemically bonded sands. System includes SDAM, transfer elevator, vibratory screener, surge hopper, and high efficiency classifier. Options include: rotary magnetic separator, cooling tubes, pneumatic transporters and more. Palmer also offers individual shakeout decks, attrition mills, sand handling/classification equipment, and pneumatic transporter systems to fully supply your sand system.



**Throughputs up to 22  
TPH (20MTPH) and  
deck loads to  
25,000 lbs**



## CAR-Series Mechanical Reclamation System

- Capacities from 1-5 TPH (0.9-4.5 MTPH)
- Shipped Skid Mounted and Ready to Run – Simply Connect Power and Begin Reclaiming Sand
- Available with Integral Dust Collector Option as well



*CAR-Series Mechanical Reclamation System  
(Shipped complete with very little on-site assembly required)*



## TSR-Series Thermal Sand Reclaimer

### Footprint/Dimensions:

- 4 ft x 12 ft x 9 tall

### Capacity range:

- From 6 tons per day to 10 tons per day

### Key attributes:

- All electric using off the shelf components.
- Simple and very easy to operate and maintain.
- Shipped assembled.
- Installs in hours.
- No cooling water system required.

### How It Operates:

- Sand is metered into a rotary calciner of unique design where it is heated to the desired temperature.
- Precisely heated sand falls into a rotating cooler with ambient air flow that cools the sand to within 25° F of ambient while removing a controlled amount of fines.
- Larger output and gas fired units available.



*TSR-Series Thermal Reclamation System*

## COREMAKING EQUIPMENT No-Bake, Cold Box, Shell

### No-Bake Core Blowers – The CM-Series

Designed with ultimate simplicity and durability in mind, the Palmer Coremaker provides foundries with an economical means for the blowing of no-bake and cold box cores. With capacities up to 500 pounds per blow, this versatile machine can be used by low volume jobbing and high volume shops economically and efficiently. With no need for scrubbers and other expensive peripheral equipment on the no-bake version, the Palmer Coremaker is a cost effective solution for virtually any foundry. This is not just a core-blower – as an added bonus, this mixer rotates 90° to allow mixed sand to discharge outboard of the coremaker footprint. This allows for molds and very large cores to be produced in a small production area. Available in five sizes:

- CM-25 up to 30 lbs (13kg) per blow
- CM-50 up to 60 lbs (27kg) per blow
- CM-100 up to 160 lbs (72kg) per blow
- CM-300 up to 350 lbs (159kg) per blow
- CM-500 up to 600 lbs (272kg) per blow



### Core Knock-Out

From a basic stationary impact machine to the top of the line impact/vibratory system we can manage complete core knock-out. We have a machine to fit all core removal needs. Our rugged design can reduce decoring time from minutes to seconds. Soundproof enclosure, sand removal equipment, and robotic integration available.



### PHB-22 and PCB-22 Core Machine –for Shell, Hot Box, or Cold Box System

PHB-22 is durable, simple to use, and comes with roll cylinders with sensors. The sensors detect when to roll and roll back. Fast automatic and semi-automatic operations: full cycle, roll cycle, cure cycle. Also offers manual control and operations. Slotted for easy bushing changes and box adjustments.



### Coremaker RFID

Palmer CM-Series CoreMakers™ are available with RFID tagging that saves the settings – program it once & forget it. RFID increases productivity many ways:

- Easy positioning – with the laser alignment guide.
- Keep operators working – let the RFID system change settings between different boxes.
- Programmable blow pressure – easily fine tune each core.
- Full PLC controls of any continuous or batch mixer

### SCRUBBER

2500 to 10,000cfm scrubbers for Amine or SO2. Scrubbers are vertical and designed for 99.9+% removal efficiency with normal inlet loading.

- Fully Fabricated from Black Polypropylene for Acid Resistance
- PVC Valves and CPVC Pump
- Clear PVC Port to View Spray Nozzle
- Includes pH Monitor
- Includes Pump, Valves, and Controls to allow automatic generation of new scrubber solution and refill of make-up water

# RETROFIT RESIN PUMPING SYSTEMS

## About Palmer Resin Pumping Systems

Palmer Pumping Systems are completely self contained units designed to eliminate the problems associated with old, worn, poorly designed systems that cause such problems as inaccurate delivery, inconsistent delivery, resin bleed back, the need for constant re-calibration, and high replacement part cost. Palmer systems are particularly helpful when used to replace pumping systems designed around high RPM, low displacement pumps. From our basic RP packages, to high-end, fully-automated mass flow control packages, Palmer has the equipment and experience to meet your exact needs.

### Standard Systems Available:

#### RP-Retrofit Pumping

Palmer RP-Retrofit Pumping Systems provides a “heart transplant” for any ailing continuous or batch sand mixer. The RP is fully contained in a NEMA enclosure and is complete with pumps, motors, air actuated ball valves, and digital DC or AC/VFD speed controls – everything needed for accurate, consistent chemical delivery. The RP can be configured for any resin system, has many options and can be built for any size mixer.

#### Volumetric Pumping Systems

The RPV is a true volumetric pumping system designed specifically for batch mixers. Tempered glass tubes receive resins from bulk storage up to the level of the close tolerance proximity detectors. When called for, the resin in the tube is metered into the batch mixer by introducing low pressure inert gas into the top of the resin tube. Once the level reaches the bottom proximity detector, the metering valve closes and the gas pressure is vented. This system is designed for years of service with minimal maintenance. The RPV is housed in a rugged NEMA 12 enclosure and is easily integrated into any batch mixer control system.

#### FlowBoss™ Pumping Systems

The FlowBoss is designed as a cost effective means of accurately monitoring and controlling liquid additions to continuous and batch mixers. Using high tolerance flow meters, the FlowBoss monitors actual liquid flow, not pump RPM. With optional PID control, the FlowBoss is a self-regulating resin metering system that provides the utmost accuracy in measurement and control at a reasonable price.

#### Mass Flow Pumping Systems

The Palmer MF System features Straight Tube Coriolis Mass Flow Meter– the most reliable meter in the industry. The straight tube design operates undisturbed in hostile, vibration prone applications and has proven itself well suited for operation in a foundry environment. These meters automatically adjust for material viscosity changes and minor line restrictions. System can include color HMI's, Ethernet capability and have the highest degree of accuracy available on the market today.

#### Bulk Transfer System

The Palmer Bulk Transfer System (BTS) draws on Palmer's decades of pumping, metering and storage of a variety of difficult to handle and store chemicals. The Palmer BTS consists of bulk storage tanks, a properly designed pumping system, small logically sized day tanks and a properly designed PLC based control system to maintain level, monitor flow rates, troubleshoot system, etc.

#### Day Tanks and Resin Distribution Systems

The Palmer Bulk Resin Distribution System features individual day tanks for each mixer. Liquid level in each of these tanks is maintained by a resin loop system from a main bulk supply pumping system and is monitored by proximity sensors. This allows bulk resin storage in one localized area to feed several mixers.



## ROLLOVER DRAW MACHINES – C-Frame & Barrel

The RD-Series ranges in size from 500 – 20,000 lbs. With models from manual to fully-automatic, the RD can be made to your exact specifications. Available in open face, C-Frame and barrel configurations. High torque hydraulic rotation ensures easy and efficient rolling of even the heaviest jobs. Simple rugged alignment design for accurate and repeatable parallelism of draw. Custom designs available.



*Barrel*



*C-Frame*

*1969 Oldsmobile Regency 98  
with Rocket 455*

## SAND CONDITIONING – Sand Heater/Cooler/Classifiers

Heats, Cools and Classifies – ALL IN ONE MACHINE! Sand heating and cooling is efficient and dust-free with Palmer's HCCL-Series Classifiers. Ensures discharged sand at preferred temperature. Removes fines through fluidization and dust collection. Fully automatic heating/cooling switchover circuitry makes operation of this unit simple and efficient. Heating and cooling controls are included as standard. Custom sizes for any temperature range and tonnage. Available with magnetic separators, secondary screeners, surge hoppers, etc. Large access panels allow for complete access to the cooler for inspection and maintenance. Available as heater only and cooler only also.



*HCCL-Series*

### Electric Sand Heaters

H-Series Sand Heaters are designed to provide "set it and forget it" sand temperature control. Utilizing fully proportional SCR controls and a unique fluidization system, each heater provides uniform sand temperature regardless of duty cycle. Fluidization air is supplied through a super high- efficiency air filtration system. A summer / maintenance bypass which allows sand to go from the bulk supply to the next process without passing through the heating chamber is standard. Optional electric fluidization blower reduces the plant compressed air requirements to minimal amounts only for valve actuation. On the rare occasion when elements need to be replaced, one complete side of the heater can be removed allowing complete access to the chamber.



*H-Series*

# MOLD HANDLERS

## Mold Handlers

The PMH line of mold handlers offers our customers a complete set of options when it comes to handling both flasked and flaskless molds. From our basic scissor-style to our full line of high capacity gantry-style units, there is a size and configuration for all requirements. No-slip urethane gripper pads available for a safe secure grip on thin-wall molds. Available in hydraulic and electric models.



PMH-2000 -HPR Scissors



PMH-1000 Scissors



PMH-H-12000 Gantry



## COMPACTION TABLES

### Compaction Tables

From 5 pound cores to 30,000 pound molds, Palmer has a compaction table to fit your exact requirements. Featuring tables with both vertical and rotary vibrators, Palmer has a table and control system to meet the needs of high quality, well compacted cores and molds with lower binder levels and increased consistency. Custom sizes are our specialty. Available to fit existing conveyor, with gravity conveyor, power conveyor, or flat topped actuation by foot pedal, push button RFID or integration with the mixer.



## MOLD & CORE COATING – Spray & Flow Coating

### Spray Coating

Palmer has developed a complete line of mold wash spray equipment with molding efficiency in mind.

KP-5 Bucket Top Coating System – use with standard 5 gallon bucket containers.

KP-55 Drum Top Coating System – use with standard 55 gallon drum containers – available skid mount and drum lift allow drum changes by one operator.

HSS-55 Spray System – A KP-55 Modified to function with many of the newer coatings with a High Solids Content.



### Flow Coating

Flow Coating Pans and Pumping Systems for any size mold – tailored to fit.

Dip tanks for cores and tunnel flow coaters. Capacity up to 40,000 lbs.

Tilting Flow Coating Machines – for in-line use, improve coating efficiency and safety.

Rotary Flow Coating Machines – for in-line use, ideal for large molds or when horizontal space is limited.



KP-5

HSS-55

## Mold Pre-heaters & Dryers

Infrared and forced air/gas systems available. Mold pre-heating is necessary as coatings readily adhere to a warm and solvent-free surface. A coating must be dried at a controlled rate at a correct amount of time to dry off solvents or water. Improper or incomplete drying may result in casting defects. Drying too quickly can result in spalling, cracks and bubbling.



# FOUNDRY EFFICIENCY TOOLS

## Replacement Mixer Blades

Palmer's long life replacement blades are ideal for any brand of continuous or batch mixer. Fabricated or investment cast from alloy steels and employing extra thick high quality tungsten carbide tips, these blades easily outlast other blades. Common mixer brands and sizes normally ship same day from stock. Custom and special blades available for all high speed continuous mixers.



## Replacement Parts

Palmer maintains over \$1 million in spare parts inventory and services literally thousands of machines globally. Most parts ordered before noon EST ship same day.

## Core Racks

Palmer's Portable Core Storage Racks are an easy way to store, protect and inventory cores. These racks are moved easily in the production area and can hold up to 2000 lbs. Special features: heat dissipating lift handles, heavy duty shelves, large industrial casters for easy mobility. Gas Struts allow one handed lifting of shelves. Available in 3 standard sizes (4, 5, and 7 shelves) each shelf measures 29" x 68". Custom sizes available.



## BULK STORAGE

### Heavy-duty Bucket Elevators

Designed by foundrymen for foundrymen, Palmer Bucket Elevators feature heavy-duty construction to prevent wear and leakage. Fully removable side plates for complete access to the elevator's internal components. Off-the-shelf motor, drive, and bearings for easy replacement. Cast iron buckets and high quality belting for the longest life. BE-Series Bucket Elevators available – up to 35 (32MTPH) tons per hour in silica sand. Other models available up to 50 (45 MTPH) tons per hour.



### Hoppers & Silos

Palmer can provide you with all of your hopper and silo needs. Standard products include mixer hoppers, bulk sack transfer hoppers and silos.

- 3000/4000 lb. stock sizes (1350kg-1800kg)
- Sight glasses to determine material level



### Vertical Lift Sand Conveyor

- Ideal for high temperature applications
- Stationary auger with rotating housing elevates sand
- Hollow auger center allows addition of cooling water to process
- VFD-based drive for metering



KLEIN PLUG-FLO®

### Transporters

In contrast to conventional pneumatic conveying systems (and the associated problems of wear and abrasion of the conveying pipes, bends and fittings) the KLEIN PLUG-FLO® system does not require fluidization or boosters to move the material through a conveying pipe line, but rather uses the natural properties of the material to achieve their transport. This system makes it possible to transport sand through the pipeline with practically no degradation making it especially suitable for granular, free flowing material with minimal



## FEEDERS – Powder & Granular

### Capacities up to 140 cu. ft. per hour

The Palmer P-Series provides accurate, consistent additions of: Red Iron Oxide, Black Iron Oxide, and Bentonite. It also works with other difficult to meter solids. Capacities from .1 to 140 cu. ft. per hour. Includes solid state DC drive. A flexible, externally massaged hopper is included. The P-Series can be custom sized for each application. A flexible, externally massaged hopper maintains a consistent density of even the hardest to handle materials around the centerless Helix in the bottom of the hopper. By maintaining a consistent density of material, the utmost accuracy can be achieved. The P-Series works especially well with materials that pack, bridge and rathole.



P-Series

## MELT SHOP Acetarc Ladles

We provide a range of heavy-duty products, manufactured by craftsmen engineers, using long proven designs combined with the latest manufacturing techniques. Our full design & manufacturing capabilities enable us to provide tailor-made solutions for your molten metal handling requirements; from initial consultation, through to final design, manufacture and commissioning. Motorized gear options (electric and pneumatic) are available. Electric gear motors are available with radio remote control and inverter speed control.



## Kit Furnaces

For melting, holding or filtering aluminum or zinc, this highly efficient furnace (up to 350 lbs per hour melt rate) is the culmination of years of experience in the aluminum industry and in our aluminum foundry. The furnace uses twelve separate heating element modules that can be replaced individually from the outside of the furnace – while the furnace is still at its melting temperature. The furnace has a 4" ceramic fiber lining and can be configured for many standard silicon carbide bowls – ranging in sizes from 400 to 1,200 lbs. A true cascading SCR drive temperature controller eliminates temperature overshoot by monitoring and controlling both aluminum temperature and heating chamber temperature. Simple uncomplicated installation can be accomplished in days instead of weeks.



## Portable Rotary Degasser for Aluminum

The Palmer Rotary Degasser is portable and light weight (under 50 lbs) with stainless steel construction for a long production life. Versatile – for dip-out or crucible furnaces with capacities from 40 to 3000 lbs. Low cost with high efficiency is achieved by using a variable speed air motor. Unique one piece lance reduces cost by eliminating shaft / impeller design. This degasser can be used with Nitrogen, Argon or proprietary gas mixes and eliminates use of hazardous degassing tablets and chlorine or Freon gasses. To handle complete aluminum quality control testing, Palmer also provides: Reduced Pressure Tester, Test Bar Mold and Spectrographic Coupon Mold.



## Reduced Pressure Tester

Whenever degassing is a requirement of the melting process, it is desirable to verify the effectiveness of the degassing process. Palmer supplies a simple, easy to use reduced pressure test unit for this verification.

To use, the operator warms a sample cup, dips the cup into the furnace for a metal sample, quickly places the sample into the vacuum chamber, and starts the vacuum pump.





### NO-BAKE MOLDING SYSTEMS

Our experienced foundry engineers provide custom designed mold and core production systems to meet your current and future requirements. We take pride in the labor saving, energy saving, and production efficient systems that Palmer has designed and installed.

### COMPLETELY INTEGRATED SAND RECLAMATION SYSTEMS

From small inexpensive skid-mounted CAR-1 reclamation systems to large 30 tons per hour shake-out deck based reclamation systems, Palmer can supply all of your reclamation needs. System components include shake-out decks, attrition mills, vibratory conveyors, cooler / classifiers, screeners, elevators, magnetic separators, hoppers, silos and Ethernet capable control systems.



*Silos*



*Transfer Car*



*Foundry Molding Loop*

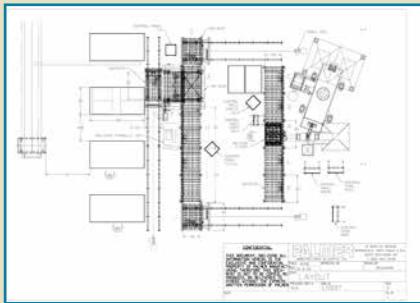

## NO-BAKE SYSTEMS, DESIGN & LAY-OUT

Our engineers visit your facility to analyze current and future production needs along with your business objectives to determine the most cost effective methods of production and often integrate current equipment and technology into the new system. We have provided engineering services to large and small foundries and welcome the opportunity to analyze your production requirements.

## CUSTOM DESIGNED AND ENGINEERED MACHINES

Palmer is a leading manufacturer of heavy-duty equipment. The Palmer difference is significant as our design and engineering department is equipped with the latest 3D CAD tools to custom design and build. Whether your needs are for a single machine or a complete facility, Palmer is your single engineering source. We take pride in our reputation for designing equipment that exceeds our customers' production goals, day-in and day-out. While others may provide basic drawings or "ideas", Palmer provides custom machine solutions that increase productivity, while reducing machinery wear and tear.

### TESTING

Palmer can perform virtually any mixing test on granular to powder materials with any liquid chemical system. Palmer can perform resin mixing tests, reclamation tests, both mechanical and thermal, as well as re-bonding cycle tests.

While our strength is in foundry sands we have performed tests and trials on frac sand, rubber crumb, adhesives, wood fiber, salt, baghouse fines, oxides, carbon, titanium, carbide, and many others.

Our laboratory, The Strausbaugh Technology Center, is equipped with the necessary equipment to perform standard foundry sand tests: LOI, ADV, Screen Analysis, Tensile Testing, Transverse Testing, pH Testing, Percent Sodium or Potassium Testing, as well as other non-foundry tests.





### SERVICE

Palmer service technicians regularly travel throughout North America, Central America and South America. Additional international service is available upon request. Our technical service team is available for installation, equipment service, training at our facility or yours, supervision of local contractors, scheduled maintenance service, solving automation problems, and emergency service. Our mission is to keep your foundry up-and-running.

Call our toll free line to speak with a skilled technician (24x7), with any troubleshooting, maintenance or installation question. With over \$1,000,000 in spare parts inventory, we have the ability to quickly handle any service call or parts shipment. Most parts ordered before noon EST can be shipped that day. Additionally, we repair ancillary and downstream equipment.



# CONTACTS

## Headquarters (Springfield, OH)

Mailing Address:  
P.O. Box 2579  
Springfield, Ohio 45501  
US/Canada: 800.457.5456  
Phone: 937.323.6339  
Fax: 937.323.2709  
E-Mail: sales@palmermfg.com  
Web: www.palmermfg.com  
Physical Address:  
18 Bechtle Avenue  
Springfield, Ohio 45504

## United States

### Alabama, Louisiana, Mississippi, Tennessee

Specialty Foundry Products  
Contact: Max Herndon  
4360 Powell Avenue  
Birmingham, AL 35222  
Phone: 800.633.4399  
Fax: 205.595.5190  
E-Mail: mherndon@specfoundry.com  
Web: www.specfoundry.com

### Arizona, California

Advanced Ceramics & Crucible  
Contact: Brian Chalmers  
P.O. Box 2732  
Wrightwood, CA 92397  
Phone: 760.249.4178  
Cell: 760.680.9567  
Fax: 760.281.8034  
E-Mail: bchalmers@advancedceramicsca.com  
Web: www.advancedceramicsca.com

### Arkansas, Kansas, Missouri, Oklahoma, Texas, Illinois

Del Sol Services  
Contact: Lee White  
Phone: 830.237.7760  
Fax: 830.935.4048  
E-mail: sales@delsolservices.com  
Web: www.delsolservices.com

### Colorado, Utah, Wyoming

United Western Supply - Denver  
Contact: Steve McCombs  
4401 E. 46th Avenue  
Denver, CO 80216  
Phone: 303.388.1224  
Fax: 303.388.0922  
E-mail: stevemccombs@uniwestdenver.com  
Web: www.unitedwesterndenver.com

### Florida, Georgia, North Carolina, South Carolina, Virginia

Metaltech Systems  
Contact: Paul Hanna  
328 Tiller Drive  
Pawleys Island, SC 29585  
Phone: 843.237.5163  
Fax: 843.237.5164  
E-mail: sales@metaltechsystems.com  
Web: www.metaltechsystems.com

### Idaho, Oregon

United Western Supply - Portland  
Contact: George Hanson  
15540 North Lombard Street Portland, OR 97203  
Phone: 503.226.4836  
Fax: 503.228.6442  
E-mail: ghanson@uniwest.us

## Southern Indiana, Ohio

Sol-Tech Group, Inc.  
Contact: Doug Agin  
4553 Fringe Tree Circle  
Mason, OH 45040  
Phone: 513.382.5146  
Fax: 513.459.7909  
E-Mail: dagin@sol-techgroup.com  
Web: www.sol-techgroup.com

## Illinois

Metcast Inc.  
Contact: Jim Hallstrom  
16211 W. Lincoln Ave.  
New Berlin, WI 53151  
Phone: 262.785.7577  
E-mail: jim@metcastservice.com  
Web: www.metcastservice.com

## Northern Indiana

Metcast Inc.  
Contact: Craig Wisner  
16211 W. Lincoln Ave.  
New Berlin, WI 53151  
Phone: 262.785.7577  
E-mail: craig@metcastservice.com  
Web: www.metcastservice.com

## Iowa, Michigan, Minnesota, Wisconsin

Metcast Inc.  
Contact: Paul Good  
16211 W. Lincoln Ave.  
New Berlin, WI 53151  
Phone: 262.785.7577  
E-mail: paul@metcastservice.com  
Web: www.metcastservice.com

## Maryland, New Jersey, New York, Pennsylvania

KJS Industrial Services, Inc.  
Contact: Keith Shaffer  
900 Delta Road  
Red Lion, PA 17356  
Phone: 717.244.2285  
Fax: 717.244.3195  
E-mail: keith@kjsind.com  
Web: www.kjsind.com

## Washington

United Western Supply - Seattle  
Contact: Dave Ashbaugh  
5245 E. Marginal Way  
South Seattle, WA 98131  
Phone: 206.767.9880  
Fax: 206.762.6901  
E-Mail: dashbaugh@uniwest.us

## Alaska, Connecticut, Delaware, Hawaii, Kentucky, Maine, Massachusetts, Montana, Nebraska, Nevada, New Hampshire, New Mexico, North Dakota, Rhode Island, South Dakota, Vermont, West Virginia

P.O. Box 2579  
Springfield, Ohio 45501  
US/Canada: 800.457.5456  
Phone: 937.323.6339  
Fax: 937.323.2709  
E-Mail: sales@palmermfg.com  
Web: www.palmermfg.com  
Physical Address:  
18 Bechtle Avenue  
Springfield, Ohio 45504

## Canada

### Alberta, Saskatchewan, Manitoba

Wesmat Supplies, Ltd.  
Contact: Craig Diachuk  
5903 - 45 Street  
Leduc, Alberta Canada T9E 7B3  
Phone: 800.663.7263  
Fax: 780.455.0091  
E-Mail: craig@wesmat.com  
Web: www.wesmat.com

## British Columbia

OCL Industrial Materials, Ltd.  
Contact: Barry Spence  
13364 Comber Way  
Surrey, British Columbia Canada V3W 5V9  
Toll Free 800.663.2869  
Phone: 604.594.5050  
Fax: 604.594.1240  
E-Mail: barry@oclim.com  
Web: www.oclim.com

## Ontario and the Maritimes

Smelko Foundry Products, Ltd.  
Contact: Tim Smelko  
701 Nipissing Road  
Milton, Ontario, Canada L9T 4Z5  
Phone: 905.878.2331  
Fax: 905.878.4445  
Email: tim@smelko.com  
Web: www.smelko.com

## Quebec

Casmatec Canada Inc.  
Contact: Yves Marchand  
3210 Joseph Simard  
Sorel-Tracy, Qc, Canada J3P 5N3  
Toll free: 888.443.3632  
Phone: 450.743.3632  
Cell: 514.715.8581  
Email: y.marchand@sympatico.ca  
Web: www.casmatec.com

## Mexico

MAZA Insumos, S.A. de C.V.  
Contact: Ing. Enrique L. Mañueco G  
Ave. Canada #114  
Fracc. Industrial Unidad Nacional II  
P.O. Box 186  
Santa Catarina, N.L. Mexico 66350  
Phone: 52.8183906350  
Fax: 52.8183906776  
E-mail: enrique@maza.com.mx  
Web: www.maza.com.mx

## Central America

Palmer Manufacturing & Supply, Inc. - South America  
Contact: Gilbert Catherwood,  
Director of Sales - South America  
Costa Rica, CA  
Phone: 506.2416.3070  
Cell: 506.8664.9150  
E-mail: gilcatherwood@gmail.com  
Web: www.palmermfg.com

## South America Argentina, Chile

Brignone & Asociados  
Contact: Eduardo S. Brignone  
Buenos Aires, Argentina  
Phone: 54.11.4901.8885  
Cell: 54(9).11.4186.9083  
Web: www.brignoneasociados.com.ar  
E-mail: eduardo@brignoneasociados.com.ar

## Colombia

Proveedores de Fundición Marora  
Contact: Jose Larrea  
Calle 7a No. 32-51  
Bogota, Colombia  
Phone: +57.1.360.8245  
Fax: +57.1.201.7690  
E-mail: jose.larrea@marora.com.ve

## Peru

C&T Representaciones, S. A.  
Contact: Eng. Carlos Calderon H.  
Eng. Eduardo Calderon B.  
Calle Santa Cecilia 527  
Urb. Los Sauces, LIMA 3, PERU  
Phones: 511.719.7542, 511.719.7544  
Fax: 511.326.0608  
E-mail: carlos\_c@cytrep.com  
E-mail: eduardoc@cytrep.com  
Web: www.cytrep.com

## Venezuela

Marora S.A.  
Contact: Jose Larrea  
Torre Centro Boyaca Oficina  
82 Av. Sucre,  
Los Dos Caminos  
Apdo. Postal 75230,  
Caracas 1070 A - Venezuela  
Phone: 58.212.2831608  
Fax: 58.212.2860416  
E-mail: jose.larrea@marora.com.ve

**CHECK  
US OUT  
online**

[www.palmermfg.com](http://www.palmermfg.com)

For more than 40 years, Palmer Manufacturing and Supply, Inc., has made customer satisfaction our number one priority. That's just one reason why Palmer Manufacturing is the largest supplier to the no-bake foundry industry in the United States. With over 100,000 square feet of manufacturing, warehouse and office space there is no project too complex for us to handle.

Palmer began as an Iron and Aluminum Green Sand No-Bake and Permanent Mold Production Foundry. Lacking heavy-duty equipment that would be both easy to operate and maintain; Palmer began developing a line of equipment to meet our needs. Using our demanding production environment to thoroughly test equipment led to the development of a line of heavy-duty easy to maintain and operate equipment.

Palmer designs easy to use equipment and complete systems that are less likely to have problems and rugged enough to withstand the toughest foundry environments. We take pride in equipment that has the best controls, is easy to configure, is exceptionally reliable and is engineered to have a long production life. Our equipment and complete systems are installed in foundries globally.

Every piece of Palmer equipment or system can be completely customized to meet your specifications. Whether we modify one of our standard models or build one to your unique requirements, you can be assured that the equipment we deliver will be of the highest quality at the most reasonable cost possible.

### Global Sales & Service

Palmer has built a reputation for outstanding customer service. Our global sales and service organization proudly supports installations throughout USA, Canada, Mexico, Costa Rica, South America, Europe, Asia and Australia.

**PALMER**  
MANUFACTURING & SUPPLY, INC.

Palmer Manufacturing & Supply, Inc.  
18 Bechtle Ave • Springfield, OH 45504  
800.457.5456



[www.palmermfg.com](http://www.palmermfg.com)



[www.palmereng.com](http://www.palmereng.com)



[www.gorillamachinery.com](http://www.gorillamachinery.com)



[www.palmergolfsolutions.com](http://www.palmergolfsolutions.com)



Made in USA

[sales@palmermfg.com](mailto:sales@palmermfg.com)  
[www.palmermfg.com](http://www.palmermfg.com)